

# MAP 1.2/1.6 & MAP ASYM 1.2/1.6

INSTALLATION INSTRUCTIONS | NOVEMBER 2022

with ground housing

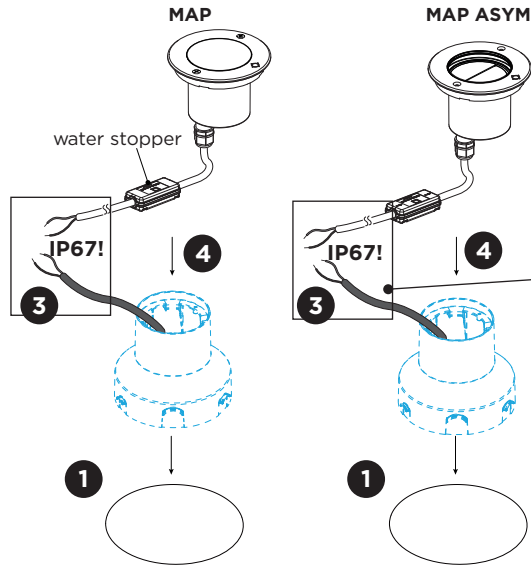

**Do not cut off or open the water stopper on the cable.**

## Included:

waterproof connectors:



## Optional:

IP68 connection box:

order ref. 73240706 = 2 WAYS 2x1,5 Ø6-8mm

Cut an opening in the ground housing to easier guide the cable sideways.

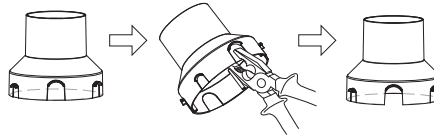

## DIMENSIONS

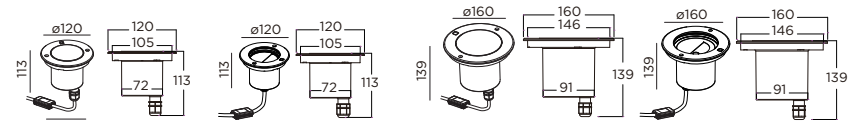

MAP 1.2

MAP ASYM 1.2

MAP 1.6

MAP ASYM 1.6

## MOUNTING INSTRUCTION WITH GROUND HOUSING

- 1 Make a hole in the ground according to the prescribed dimensions (of the ground housing).
- 2 Drainage: we recommend that all exterior groundspots should be installed with a drainage level even when using a recessed housing.

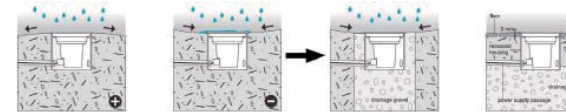

## POWER CONNECTION

- 3 Connect to 220-240V.
- 4 Use screws to attach the fixture to the ground housing, screws are included.

optional ground housing

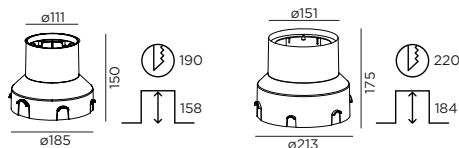

90012203  
for MAP 1.2  
for MAP ASYM 1.2

90012204  
for MAP 1.6  
for MAP ASYM 1.6



**WEVER & DUCRÉ**  
LIGHTING

**WEVER & DUCRÉ BV**  
Spinnerijstraat 99/21, 8500 Kortrijk, Belgium  
weverducre.com

PB19-010-772-00\_v2

# MAP 1.2/1.6 & MAP ASYM 1.2/1.6

INSTALLATION INSTRUCTIONS | NOVEMBER 2022

## without ground housing

A. Attached to the floor (or wall, for wall mounting).

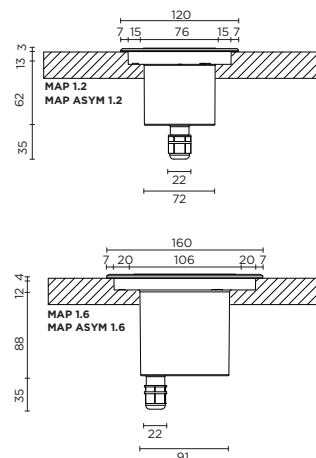
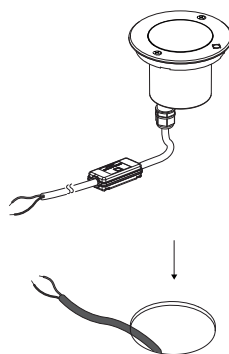

B. Rests on the stainless steel borders of the fixture.

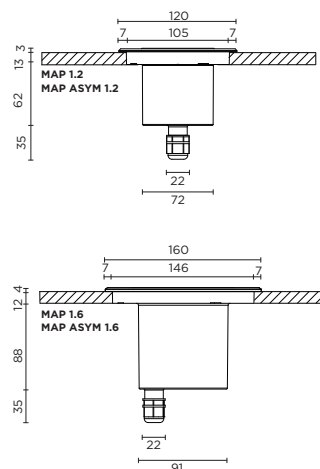
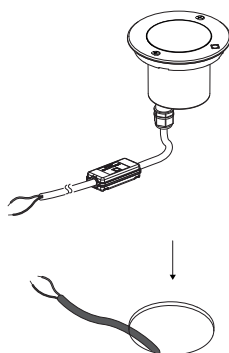

## MOUNTING INSTRUCTION WITHOUT GROUND HOUSING

A. Attached to the floor (or wall, for wall mounting).

- 4 Use the screws (included) to attach the luminaire to the floor or wall. Make sure to measure correctly so that you can screw into a hard material.

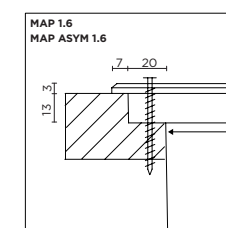
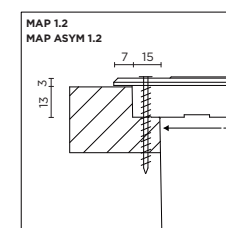

B. Rests on the stainless steel borders of the fixture.

- 4 Place the luminaire into the hole. No tool is needed to fix the luminaire as it will rest on the stainless steel frame.

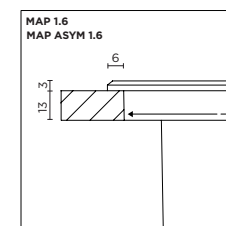
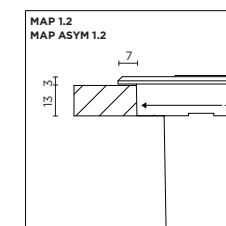

Note:  
the bolts and  
nuts can be used  
for filling the  
screwholes.

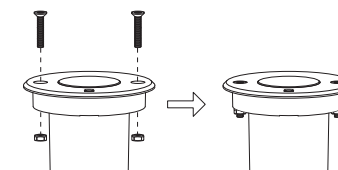

# MAP 1.2/1.6 & MAP ASYM 1.2/1.6

INSTALLATION INSTRUCTIONS | NOVEMBER 2022

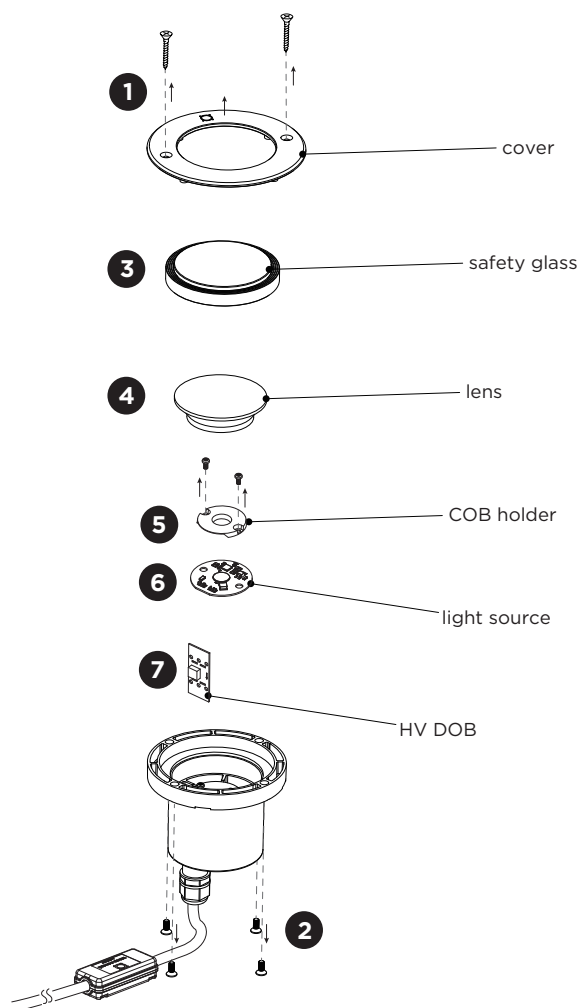

## DISMOUNTING AND RECYCLING INSTRUCTIONS

### Light source

- 1 Remove the screws and take out the fixture.
- 2 Remove the four screws below and remove the cover.
- 3 Remove the safety glass.
- 4 Remove the lens.
- 5 Remove the screws and the COB holder.
- 6 Disconnect the wires and remove the light source.
- 7 Remove the HV DOB.

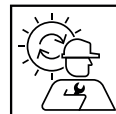

The light source is replaceable by an authorized professional.  
For advice contact your Wever & Ducré customer service contact point.



This luminaire contains a light source with the energy class F.