

# ROOMOR TABLE 1.0

10-Sep.-2018

## ROOMOR TABLE 1.0 PAR16

max. 35W | GU10 | 100-240VAC | 50-60Hz  
 CE IP20 45°/45° 30°/30°

### BODY COLOUR

<span style="display:inline-block; width:10px; height:10px; background-color:red; border:1px solid black;"></span> red texture	637120R_
<span style="display:inline-block; width:10px; height:10px; background-color:grey; border:1px solid black;"></span> grey texture	637120G_
<span style="display:inline-block; width:10px; height:10px; background-color:black; border:1px solid black;"></span> black texture	637120B_

### OPTIONAL

No shade	00
----------	----

### SHADE 1.0

<span style="display:inline-block; width:10px; height:10px; background-color:black; border:1px solid black;"></span> black texture	B1
<span style="display:inline-block; width:10px; height:10px; background-color:red; border:1px solid black;"></span> red texture + white	R1
<span style="display:inline-block; width:10px; height:10px; background-color:grey; border:1px solid black;"></span> grey texture + white	G1
<span style="display:inline-block; width:10px; height:10px; background-color:black; border:1px solid black;"></span> black texture + gold	K1
<span style="display:inline-block; width:10px; height:10px; background-color:grey; border:1px solid black;"></span> felt grey (max.15W)	F1

for PAR16 lamps see our catalogue

### SHADE 1.0

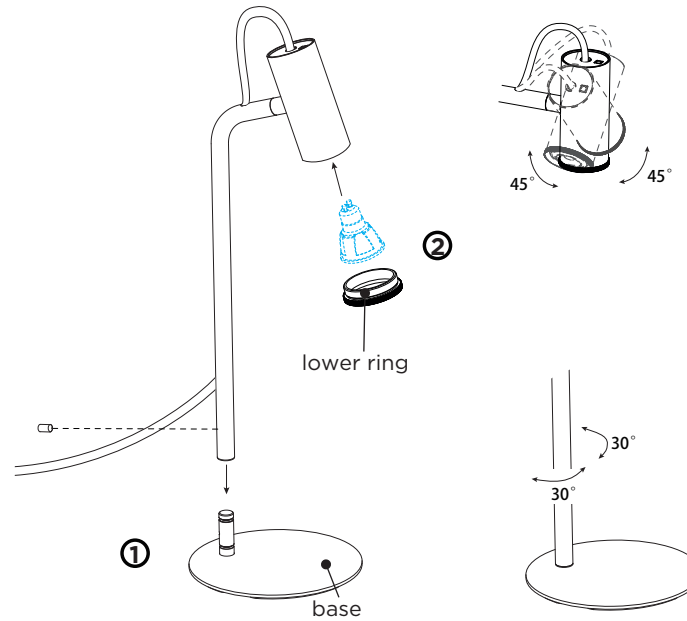
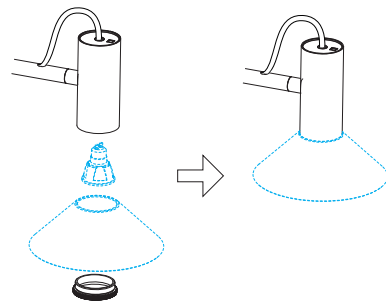

### DIMENSIONS

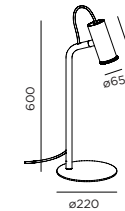

ROOMOR TABLE 1.0

### MOUNTING INSTRUCTION

- ① Install the lamppost on the base; and lock them with the allen screw.
- ② Unscrew the lower ring of the luminaire body, install a bulb (bulb is not included), and then screw the lower ring back.
- ③ Power connected with the plug.

